



LIGHTING FOREVER

5 PIN LONG CREEPAGE SOP PHOTOTRANSISTOR PHOTOCOUPLER

EL111X-G Series

Features:

- Free halogens compliant
- Current transfer ratio
(CTR: 50~600% at $I_F = 5\text{mA}$, $V_{CE} = 5\text{V}$)
(CTR: 63~320% at $I_F = 10\text{mA}$, $V_{CE} = 5\text{V}$)
- High isolation voltage between input and output (Viso=5000 V rms)
- Compact 5 Pin SOP with a 2.0 mm profile
- 8mm long creepage distance
- Pb free and RoHS compliant.
- CUL approval (No. E214129)
- VDE approval (No. 40028391)
- SEMKO approved (pending)
- NEMKO approved (pending)
- DEMKO approved (pending)
- FIMKO approved (pending)

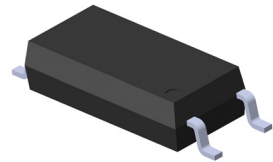

Description

The EL111X-G series devices consist of an infrared emitting diode, optically coupled to a phototransistor detector. Compound use free halogens and Sb_2O_3 . They are packaged in a 5-pin SOP package.

Schematic

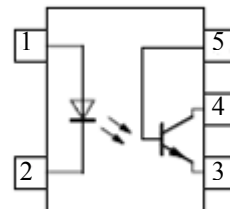

Pin Configuration

1. Anode
2. Cathode
3. Emitter
4. Collector
5. Base

Applications

- Programmable controllers
- System appliances, measuring instruments
- Telecommunication equipments
- Home appliances, such as fan heaters, etc.
- Signal transmission between circuits of different potentials and impedances



LIGHTING FOREVER

5 PIN LONG CREEPAGE SOP PHOTOTRANSISTOR PHOTOCOUPLER

EL111X-G Series

Absolute Maximum Ratings ($T_a=25^{\circ}\text{C}$)

Parameter		Symbol	Rating	Unit
Input	Forward current	I_F	60	mA
	Peak forward current (1us, pulse)	I_{FP}	1.5	A
	Reverse voltage	V_R	6	V
	Power dissipation	P_D	100	mW
Output	Power dissipation	P_C	150	mW
	Collector current	I_C	50	mA
	Collector-Emitter voltage	V_{CEO}	80	V
	Emitter-Collector voltage	V_{ECO}	7	V
Total power dissipation		P_{TOT}	250	mW
Isolation voltage ^{*1}		V_{ISO}	5000	V rms
Operating temperature		T_{OPR}	-55 ~ +110	$^{\circ}\text{C}$
Storage temperature		T_{STG}	-55 ~ +125	$^{\circ}\text{C}$
Soldering temperature ^{*2}		T_{SOL}	260	$^{\circ}\text{C}$

Notes

*1 AC for 1 minute, R.H.= 40 ~ 60% R.H. In this test, pins 1 & 2 are shorted together, and pins 3 & 4 are shorted together.

*2 For 10 seconds.



LIGHTING FOREVER

5 PIN LONG CREEPAGE SOP PHOTOTRANSISTOR PHOTOCOUPLER

EL111X-G Series

Electrical Characteristics ($T_a=25^\circ\text{C}$ unless specified otherwise)

Input

Parameter	Symbol	Min.	Typ.*	Max.	Unit	Condition
Forward voltage	V_F	-	-	1.5	V	$I_F = 50\text{mA}$
Reverse current	I_R	-	-	10	μA	$V_R = 6\text{V}$
Input capacitance	C_{in}	-	50	-	pF	$V = 0, f = 1\text{kHz}$

Output

Parameter	Symbol	Min.	Typ.*	Max.	Unit	Condition
Collector-Emitter dark current	I_{CEO}	-	-	100	nA	$V_{CE} = 20\text{V}, I_F = 0\text{mA}$
Collector-Emitter breakdown voltage	BV_{CEO}	80	-	-	V	$I_C = 0.1\text{mA}$
Emitter-Collector breakdown voltage	BV_{ECO}	7	-	-	V	$I_E = 0.1\text{mA}$

Transfer Characteristics ($T_a=25^\circ\text{C}$ unless specified otherwise)

Parameter	Symbol	Min.	Typ.*	Max.	Unit	Condition		
Current Transfer ratio	EL1110	CTR	50	-	600	%	$I_F = 5\text{mA}, V_{CE} = 5\text{V}$	
	EL1116		100	-	300			
	EL1117		80	-	160			
	EL1118		130	-	260			
	EL1119		200	-	400			
	EL1112	CTR	63	-	125	%	$I_F = 10\text{mA}, V_{CE} = 5\text{V}$	
	EL1113		100	-	200			
	EL1114		160	-	320			
	EL1112		22	-	-			$I_F = 1\text{mA}, V_{CE} = 5\text{V}$
	EL1113		34	-	-			
	EL1114		56	-	-			
	Collector-Emitter saturation voltage	$V_{CE(sat)}$	-	-	0.4	V	$I_F = 10\text{mA}, I_C = 1\text{mA}$	
Isolation resistance	R_{IO}	5×10^{10}	-	-	Ω	$V_{IO} = 500\text{Vdc}, 40\sim 60\% \text{ R.H.}$		
Floating capacitance	C_{IO}	-	-	1.0	pF	$V_{IO} = 0, f = 1\text{MHz}$		



LIGHTING FOREVER

5 PIN LONG CREEPAGE SOP PHOTOTRANSISTOR PHOTOCOUPLER

EL111X-G Series

Transfer Characteristics ($T_a=25^\circ\text{C}$ unless specified otherwise)

Turn on time	Ton	-	4	-	μs	$V_{CE} = 5\text{V}, I_C = 5\text{mA},$ $R_L = 100\Omega$
Turn off time	Toff	-	3	-		
Rise time	t_r	-	2	18	μs	$V_{CE} = 5\text{V}, I_C = 5\text{mA},$ $R_L = 100\Omega$
Fall time	t_f	-	3	18	μs	

* Typical values at $T_a = 25^\circ\text{C}$

5 PIN LONG CREEPAGE SOP PHOTOTRANSISTOR PHOTOCOUPLER

EL111X-G Series

Typical Performance Curves

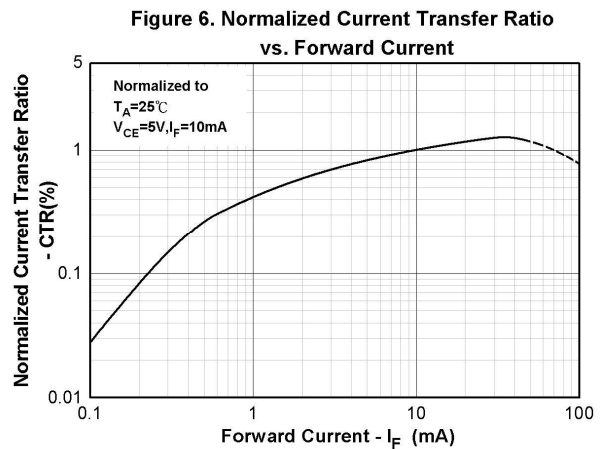
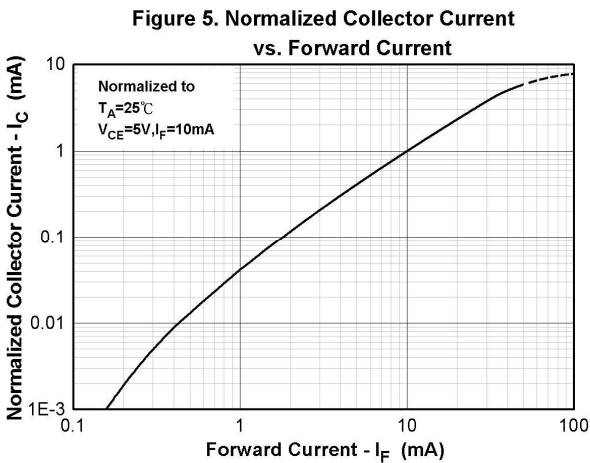
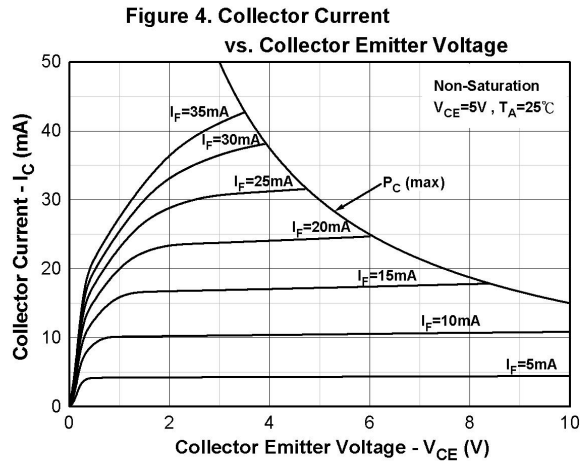
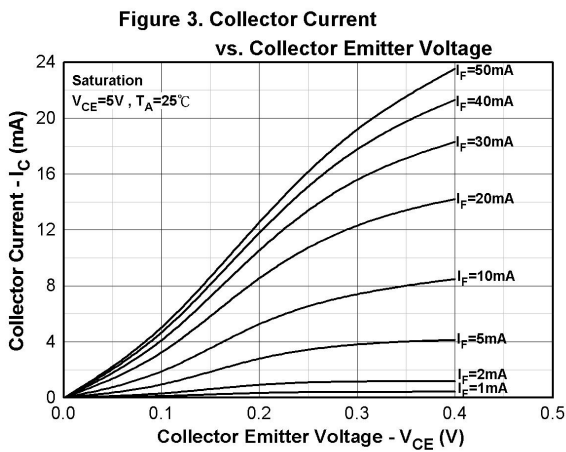
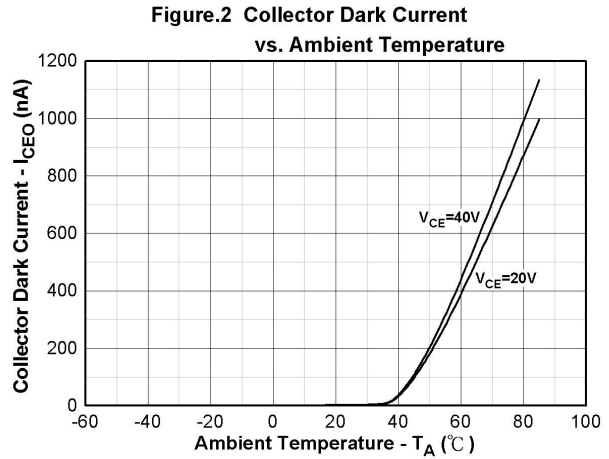
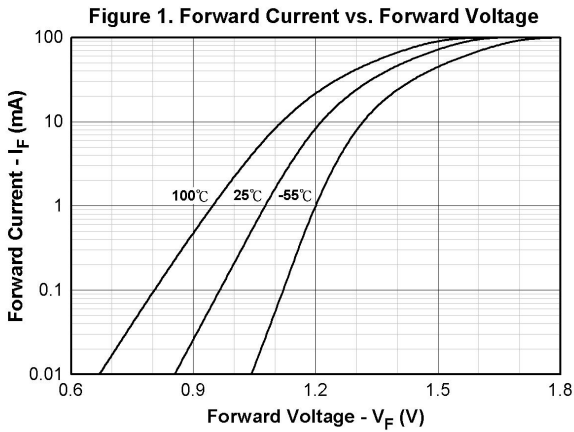

5 PIN LONG CREEPAGE SOP PHOTOTRANSISTOR PHOTOCOUPLER

EL111X-G Series

Figure 7. Normalized Current Transfer Ratio vs. Ambient Temperature

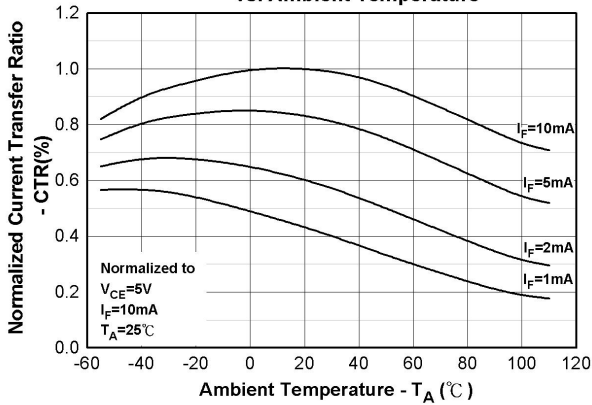

Figure 8. Normalized Current Transfer Ratio vs. Ambient Temperature

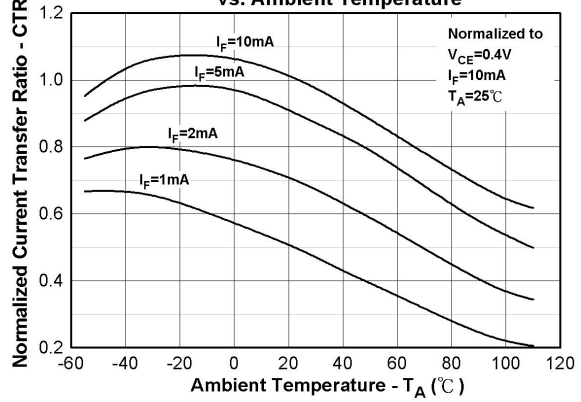

Figure 9. Turn on/off Time vs. Collector Current

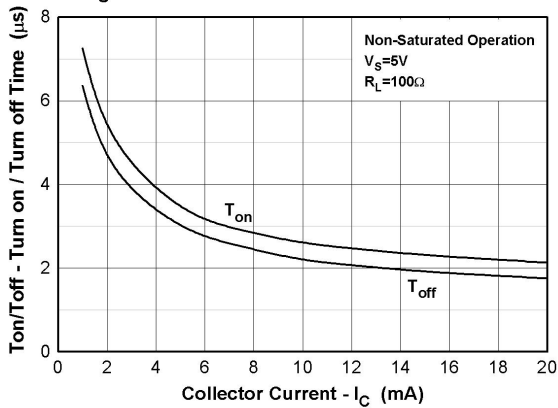

Figure 10. Turn on/off Time vs. Forward Current

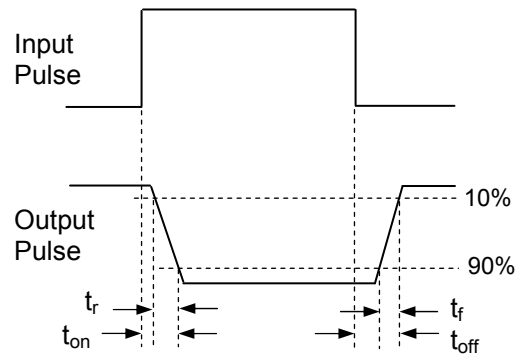
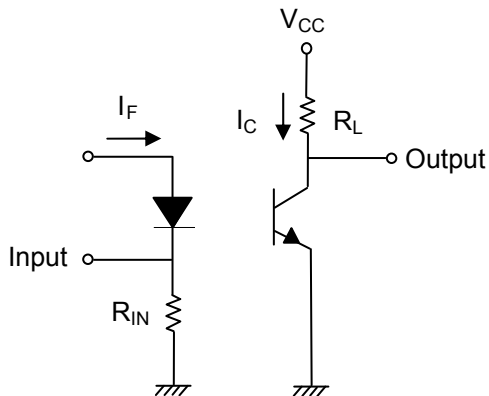
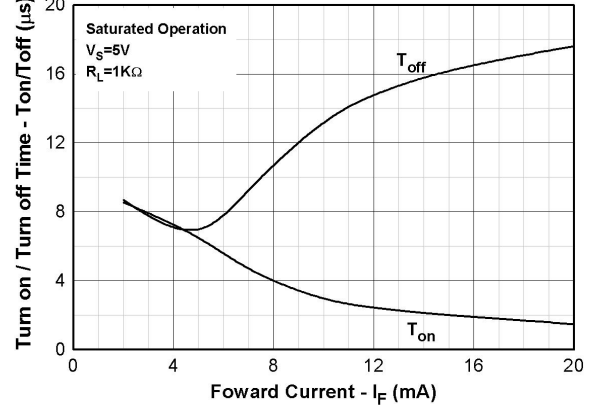

Figure 11. Switching Time Test Circuit & Waveforms



LIGHTING FOREVER

5 PIN LONG CREEPAGE SOP PHOTOTRANSISTOR PHOTOCOUPLER

EL111X-G Series

Order Information

Part Number

EL111X(Y)-VG

Note

EL111 = Part No.

X = CTR Rank (0, 2, 3, 4, 7, 8 or 9)

Y = Tape and reel option (TA, TB or none).

V = VDE safety (optional)

G = Halogens free

Option	Description	Packing quantity
None	Standard SMD option	100 units per tube
-V	Standard SMD option + VDE	100 units per tube
(TA)	TA Tape & reel option	2000 units per reel
(TB)	TB Tape & reel option	2000 units per reel
(TA)-V	TA Tape & reel option + VDE	2000 units per reel
(TB)-V	TB Tape & reel option + VDE	2000 units per reel

**5 PIN LONG CREEPAGE SOP
PHOTOTRANSISTOR PHOTOCOUPLER**

EL111X-G Series

Package Drawing
(Dimensions in mm)

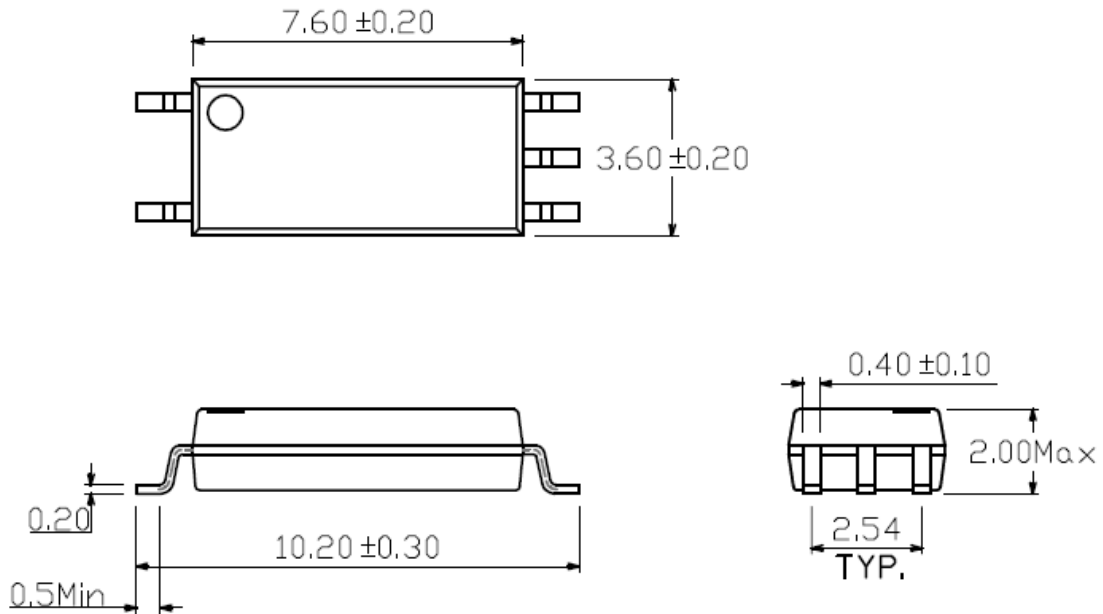

Recommended pad layout for surface mount leadform

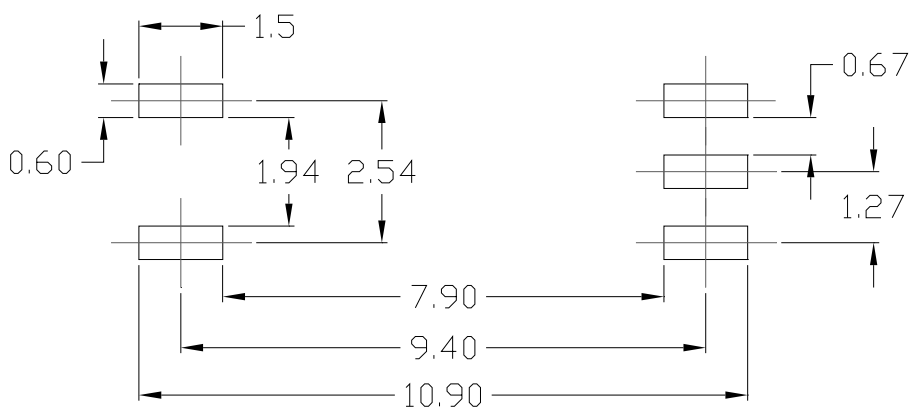



LIGHTING FOREVER

5 PIN LONG CREEPAGE SOP PHOTOTRANSISTOR PHOTOCOUPLER

EL111X-G Series

Device Marking

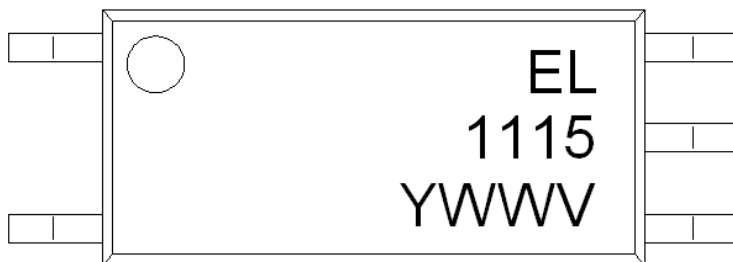

Notes

EL	denotes Everlight
1115	denotes Device Number
Y	denotes 1 digit Year code
WW	denotes 2 digit Week code
V	denotes VDE (optional)

5 PIN LONG CREEPAGE SOP PHOTOTRANSISTOR PHOTOCOUPLER

EL111X-G Series

Tape & Reel Packing Specifications

Option TA

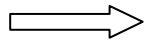
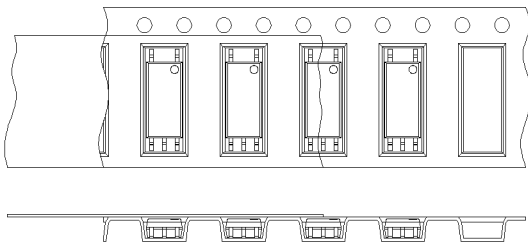

Direction of feed from reel

Option TB

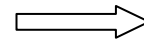
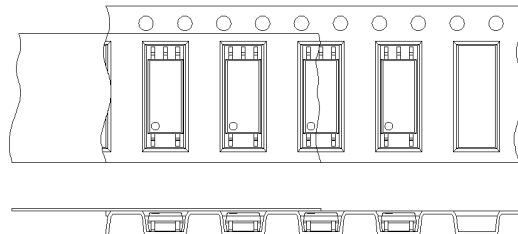

Direction of feed from reel

Tape dimensions

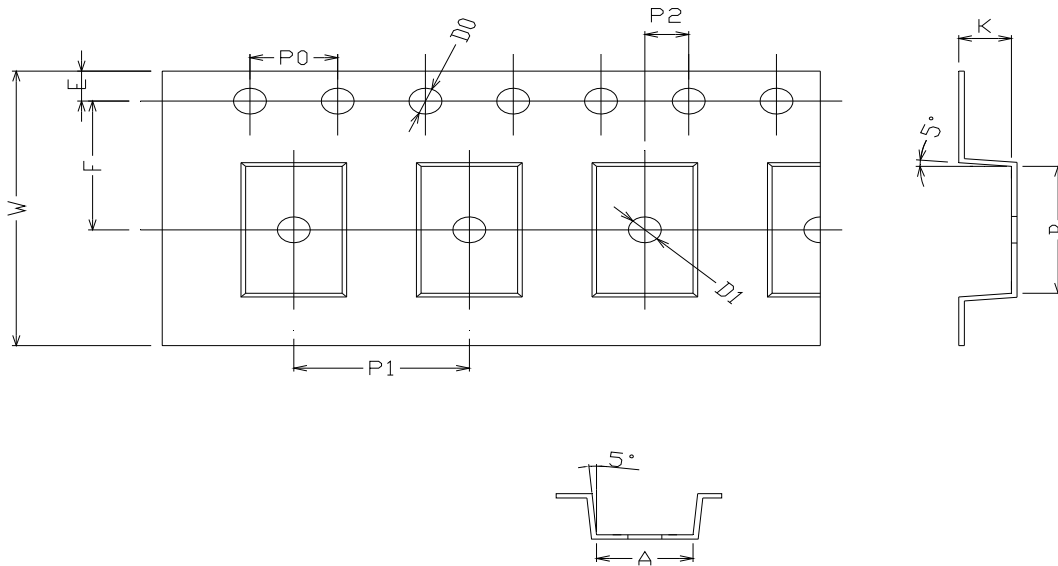

Dimension No.	A	B	Do	D1	E	F
Dimension (mm)	4.4 ± 0.1	10.5 ± 0.1	1.5 + 0.1/-0	1.5 ± 0.1	1.75 ± 0.1	7.5 ± 0.1

Dimension No.	Po	P1	P2	t	W	K
Dimension (mm)	3.8 ± 0.1	8.0 ± 0.1	2.0 ± 0.1	0.3 ± 0.05	16.0 ± 0.3	2.14 ± 0.1



LIGHTING FOREVER

5 PIN LONG CREEPAGE SOP PHOTOTRANSISTOR PHOTOCOUPLER

EL111X-G Series

Solder Reflow Temperature Profile

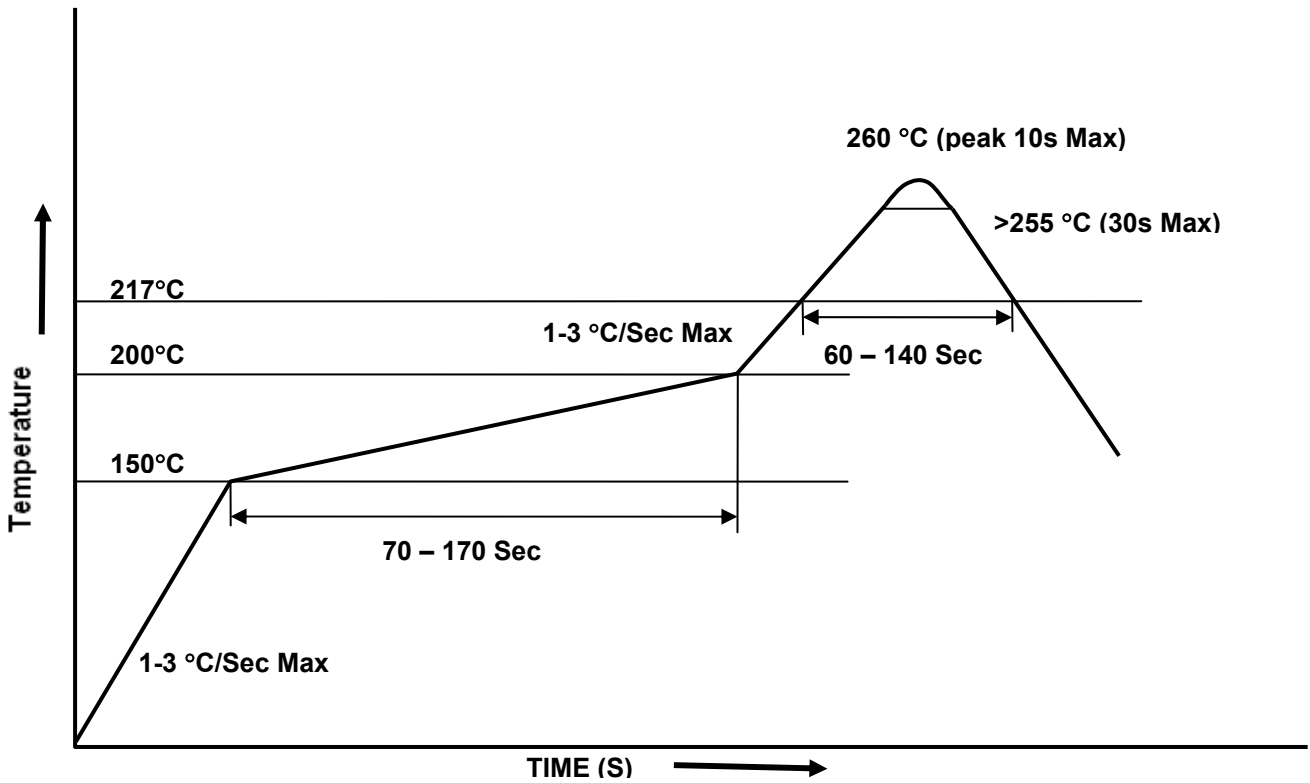



LIGHTING FOREVER

5 PIN LONG CREEPAGE SOP PHOTOTRANSISTOR PHOTOCOUPLER

EL111X-G Series

DISCLAIMER

1. The specifications in this datasheet may be changed without notice. EVERLIGHT reserves the authority on material change for above specification.
2. When using this product, please observe the absolute maximum ratings and the instructions for use as outlined in this datasheet. EVERLIGHT assumes no responsibility for any damage resulting from use of the product which does not comply with the absolute maximum ratings and the instructions included in this datasheet.
3. These specification sheets include materials protected under copyright of EVERLIGHT. Reproduction in any form is prohibited without the specific consent of EVERLIGHT.